

Auto-Darkening Welding Helmet

LY600 Auto-Darkening Lens

User Manual

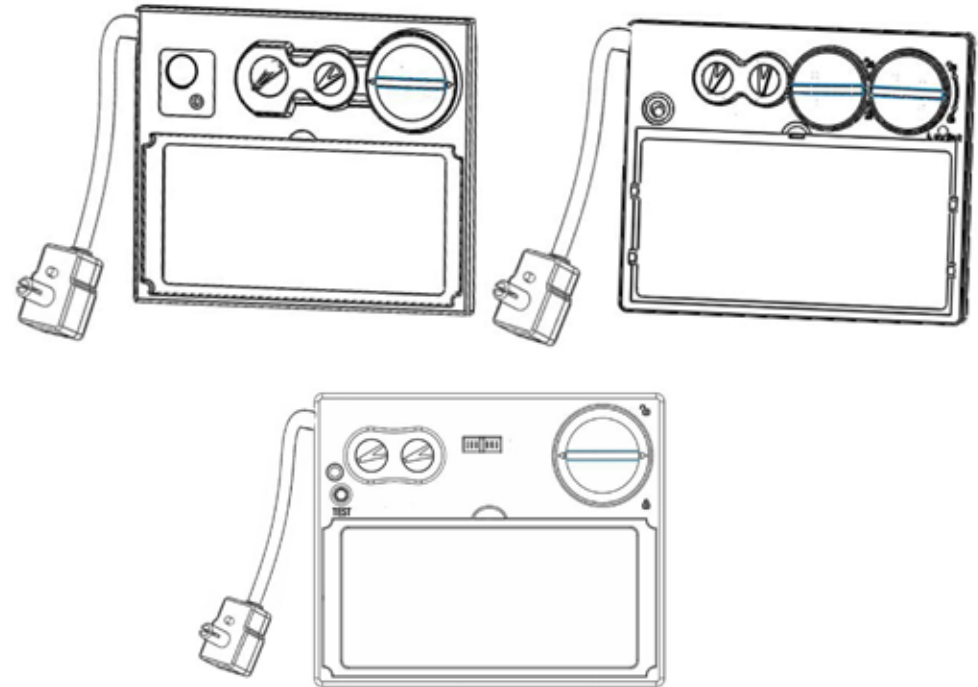

Prior to welding, please be aware of all potential hazards and follow OSHA Industrial safety practices at all times.

Before using this product, read the manual and become familiar with all operational adjustments and features.

WARNING: Misuse, improper settings, or use of a defective lense may result in permanent eye damage. Do not use this product unless you are certain it is adjusted, and functioning properly.

I. Main Features:

1. The design of this helmet provides a stylish ergonomic design with user operation and comfort in mind. The materials used in its construction are light weight, resilient to temperature fluctuation, corrosion, and short term exposure to flame. It is strongly suggested that you wear appropriate attire when welding to protect your scalp, neck, ears, and any other part of your body that may be subject to heat, spark, UV rays, or flames when welding.
2. The liquid crystal Auto-Darkening lens is designed to give the operator protection from Ultra Violet and Infrared rays up to a level of #16.
3. The lens is able to react to the arc and darken in 1/10,000 of a second.
4. The anti-interference switch prevents the lens from flickering due to other light sources in the surrounding area.
5. Stepless shade control allows operator to adjust lens shade manually as desired. It is never recommended to arc weld below the #10 setting.
6. Dark to light adjustment range: 0.1 s - 0.8 s
7. Grinding function included.

II. Model Editor Instruction

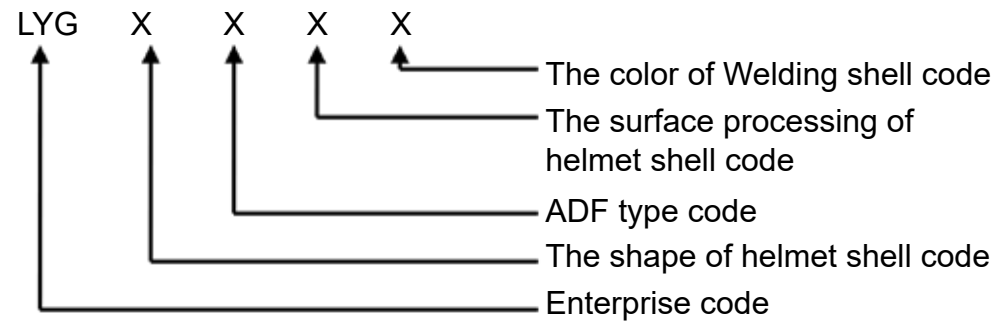

III. Main Technical Parameter

Filter Model	LY600A	LY600B	LY600C	LY600L
Filter Size	110mm x 90mm x 9mm			
Active Viewing Area	92.5 x 42.5	100 x 50	92.5 x 42.5	92.5 x 42.5
Light Shade	DIN4		DIN4.5	DIN4
Dark Shade	DIN9 ~ 13		DIN8.5 ~ 12.5	DIN9 ~ 13
Ways to shift Dark State	Outer control, stepless shift			
Switching Time	≤ 3/10000S			
Sensitivity Adjustment	Stepless Control			
Delay Time	0.1S ~ 0.8S			
Power Supply	Lithium Battery & Solar supply			
Rated Capacity of Lithium Battery	CR2450 600mAh	2*CR2032 420mAh	CR2450 600mAh	CR2477 1100mAh
Replaceable Lithium Battery	Yes			
Operating Temperature	-20°C ~ +65°C			
Sensors to Weld Arc	2			
Protect Grade Against UVB	DIN16			
Grind	Yes			
Low Battery	Yes			
Test	Yes			
LED Lamp	No			Yes

IV. Headband Installation

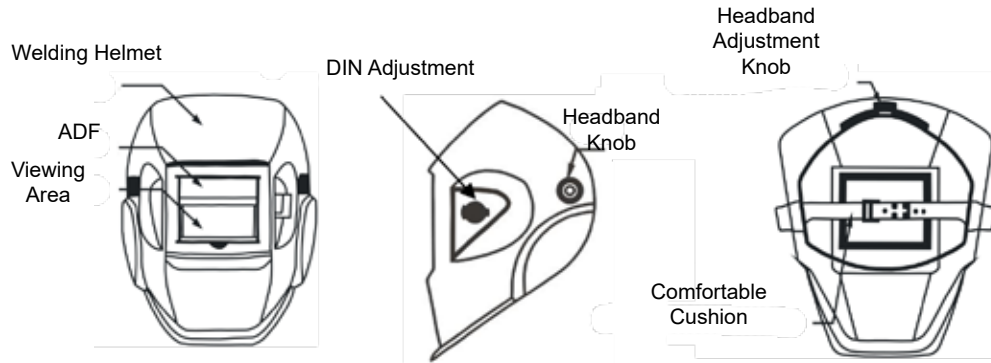

1. Headband Assembly

A. Take out the headband, and disassemble it according to the exploded view below:



Notes:

1. Two small plastic parts disked are similar but distinguished as left and right; they must be assembled according in order for the headgear to pivot properly.
2. Sweatband and should be cleaned or replaced regularly.

B. If the helmet does not come assembled, install according to the exploded view below:

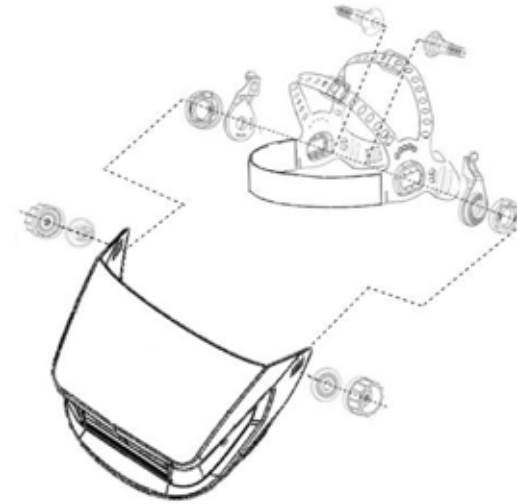

2. Description of Headgear Adjustment

A. Compress the headband adjustment knob at the rear and turn left/right to adjust headband size.

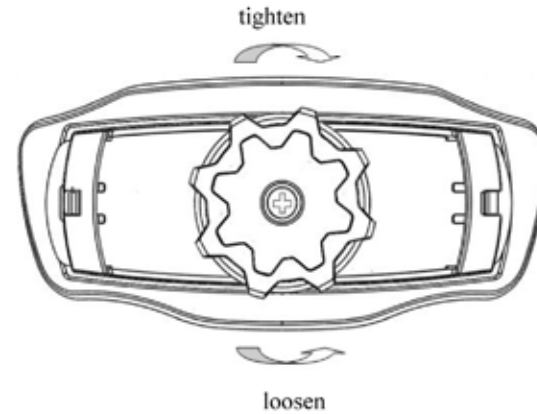

B. Headband depth can be adjust by changing the position of the band using the adjustment pins and holes.

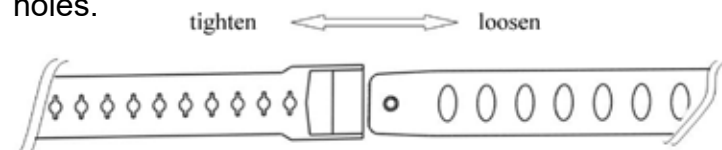

- C. Helmet mask can be adjusted in or out from the operators face, by loosening the lug nuts on either side of the helmet and adjust the headgear in or out.

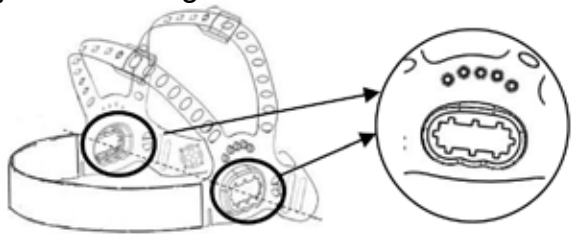

- D. Lens angle can be changed by moving cogs in the various holes in the headgear band.

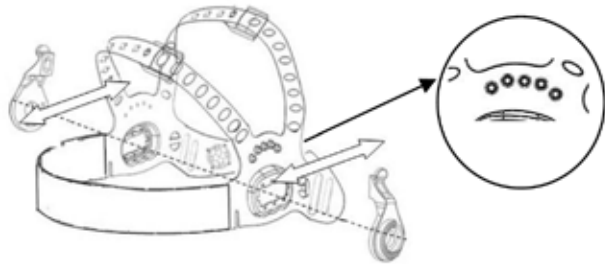

V. Auto-Darkening Lens Operation Instructions:

1. Darkness Shade:

The table below shows general recommendation settings. Please select the correct darkness shade based on optimal protection and working conditions.

Welding current (A)	0,5	2,5	10	20	40	80	125	175	225	275	350	450
Welding type	1	5	15	30	60	100	150	200	250	300	400	500
SMW				9	10		11		12		13	14
MIG (heavy)						10	11		12		13	14
MIG (light)						10	11	12	13		14	15
TIG, GTAW			9	10	11		12		13		14	
MAG/ (CO2)					10	11	12		13		14	15
SAW							10	11	12	13	14	15
PAC						11		12			13	
PAW		8	9	10	11	12		13		14		15

2. Sensitivity Adjustment:

Choose the appropriate sensitivity setting to minimize unwanted lens activation.

- When using a low arc current, set the sensitivity knob to high.
- When using a high arc current, set the sensitivity knob to low.
- Sensitivity adjustment control is stepless and can be fine tuned by the operator as desired.

3. Delay Time:

Delay time is time from dark to light, stepless control.

- When using a high arc current, delay knob should be adjusted to high.
- When spot welding or tacking delay knob can be set to low.
- Dark to light delay time is stepless and fine tuned.

4. Welding & Grinding Functions:

This function is able to be switched on or off through the knob on the helmet of the body. When the "Grind" function is active the auto darkening filter will not turn black when detecting any arc light. Never weld when helmet is set to grind function.

5. "TEST" Button:

If you press the "TEST" button and results in the filter turning black, then the filter is working.



6. Low Battery Alarm:

When the light for Low Battery is red, battery needs to be replaced. See diagram below for directions.



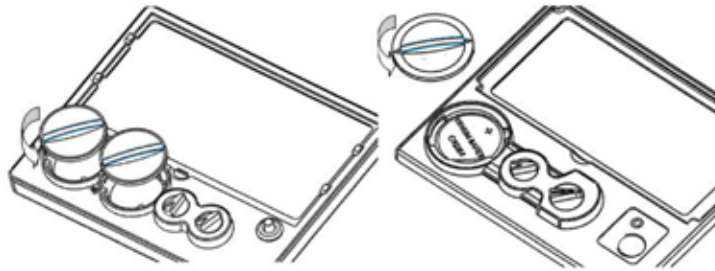

VI. Precautions for Use of Helmet:

1. Before using the auto-darkening welding helmet, you must remove the protected film on inside and outside of lens and make sure that the headgear is properly installed and adjusted.
2. Before using the helmet, please test the auto-darkening lens by placing it in front of a standard 40 watt light bulb. The auto-darkening feature should activate when placed near the bulb.
3. Do not place the helmet on high temperature surfaces.
4. Do not use the welding helmet as a safety helmet, as it offers no impact protection.
5. Clean or replace the clear protective lens on the outside of the helmet as required.
6. Never clean the auto-darkening lens with any type of liquid or solvent, use only a soft cloth or tissue for cleaning.
7. When the ambient temperature drops to near the low range of operation the auto-darkening feature may react slower than normal, however the protection properties of the lens remains in affect.

VII. ADF Filter:

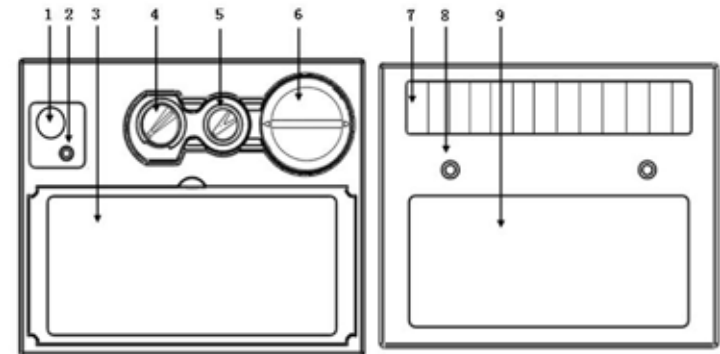

LY600A/LY600C

- | | |
|-----------------------------|--------------------|
| 1. ADF Self-check button | 6. Lithium Battery |
| 2. Low volume alarm | 7. Solar cell |
| 3. LCD protect plate | 8. Sensor |
| 4. Sensitivity control knob | 9. UV, IR filter |
| 5. Delay time control knob | |

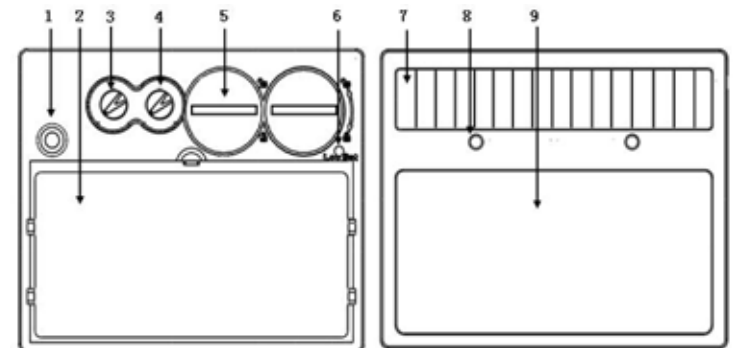

LY600B

- | | |
|-----------------------------|---------------------|
| 1. ADF Self-check button | 6. Low volume alarm |
| 2. LCD protect plate | 7. Solar cell |
| 3. Sensitivity control knob | 8. Sensor |
| 4. Delay time control knob | 9. UV, IR filter |
| 5. Lithium Battery | |

VIII. Service Information:

Should you need any help during assembly or use of this product, please contact your distributor. Should the auto-darkening lens fail during the first year of ownership you may be eligible for a free replacement providing you return the failed lens to your distributor for inspection (shipping cost are not included). Other components are not warranty unless proven to be defective prior to use.

Note: Any signs of intentional damage to the product shall nullify any warranty.

Warning: All welding should be done in accordance to OSHA standards and protective gear should be used at all times. If you are unsure of any welding safety procedures, please consult a professional.

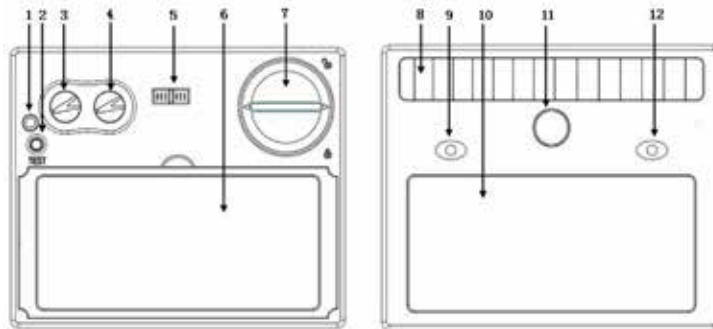

LY600L

- | | |
|-----------------------------|--------------------|
| 1. Low volume alarm | 7. Lithium Battery |
| 2. ADP Self-check button | 8. Solar cell |
| 3. Sensitivity control knob | 9. Sensor |
| 4. Delay time control knob | 10. UV, IR filter |
| 5. LED lamp control button | 11. LED lamp |
| 6. LCD protect plate | 12. Sensor |

Please record the following data:

Warranty Card

Helmet Model Number	
Place of Purchase	
Date of Purchase	
Invoice Number	

Please visit www.springcreekproducts.com for updates to this information.